



# The Open Civil Engineering Journal

Content list available at: [www.benthamopen.com/TOCIEJ/](http://www.benthamopen.com/TOCIEJ/)

DOI: 10.2174/1874149501711010757



## RESEARCH ARTICLE

# A Comparative Study of Distribution Structure Cross Arms

Ramana Pidaparti<sup>1</sup> and Sriram Kalaga<sup>2,\*</sup><sup>1</sup>School of Engineering, University of Georgia, Athens, Georgia, USA<sup>2</sup>Ulteig Engineers, Inc., St. Paul, Minnesota, USA

Received: January 03, 2017

Revised: March 15, 2017

Accepted: May 05, 2017

### Abstract:

#### Background:

The structural performance of cross arms used on distribution poles is studied in this paper. Tangent and Dead End configurations involving conventional (wood) and composite (fiber glass) cross arms are analyzed. Strength-to-Stiffness and Weight-to-Stiffness ratios associated with study cases are determined and evaluated.

#### Results and Conclusion:

It is observed that although initial costs are higher, composite cross arms offer long-term advantages in terms of strength, stiffness, performance and durability.

**Keywords:** Composite, Cross arms, Dead ends, Distribution lines, Stiffness, Strength, Tangent, Wood.

## 1. INTRODUCTION

In the electrical utility industry, lines of voltages 35 kV and below are generally termed distribution lines. Cross arms are horizontal elements used on distribution line structures to support insulators and conductors of various configurations. Figs. (1a and 1b) show a typical tangent (suspension) and a dead end cross arm configuration, respectively. Wood cross arms are traditionally used by utilities, although during the past decade, composite (fiber-reinforced) poles and cross arms are increasingly becoming popular [1]. Some of the advantages of composite cross arms include lighter weight, excellent strength and stiffness, low conductivity, moisture and corrosion resistance, ease of installation, minimum maintenance and durability.

Wood distribution cross arm sizes and design are standardized by the Rural Utilities Service (RUS) of United States Department of Agriculture [2 - 4] on the basis of length and pattern/location of insulator attachments. RUS Bulletin 1724E-151 [5] discusses the structural loading and analysis of distribution cross arms. The design of composite utility poles and structures is governed by ASCE Manual 104 [6] and the NESC [7]; however, the Manual does not address cross arms specifically. NESC specifies load and strength factors required for design.

From strength perspectives, allowable loads per load point for wood arms are derived simply on the basis of designated ultimate bending stress and recommended strength reduction factors. For composite arms, allowable loads per load point are obtained on the basis of test loads and deflections. NESC recommends a strength factor of 1.00 for composite cross arms. Most composite materials possess high strength-to-stiffness ratios thus permitting *poles* to be designed to be as flexible as needed. However, there is no information available on this flexibility aspect as it refers to composite cross arms.

\* Address correspondence to this author at the Ulteig Engineers, Inc., 4285 North Lexington Avenue, St. Paul, Minnesota 55126, USA, Tel: (651) 415 3873, Fax: (888) 858 3440; E-mail: [sriram.kalaga@ulteig.com](mailto:sriram.kalaga@ulteig.com)

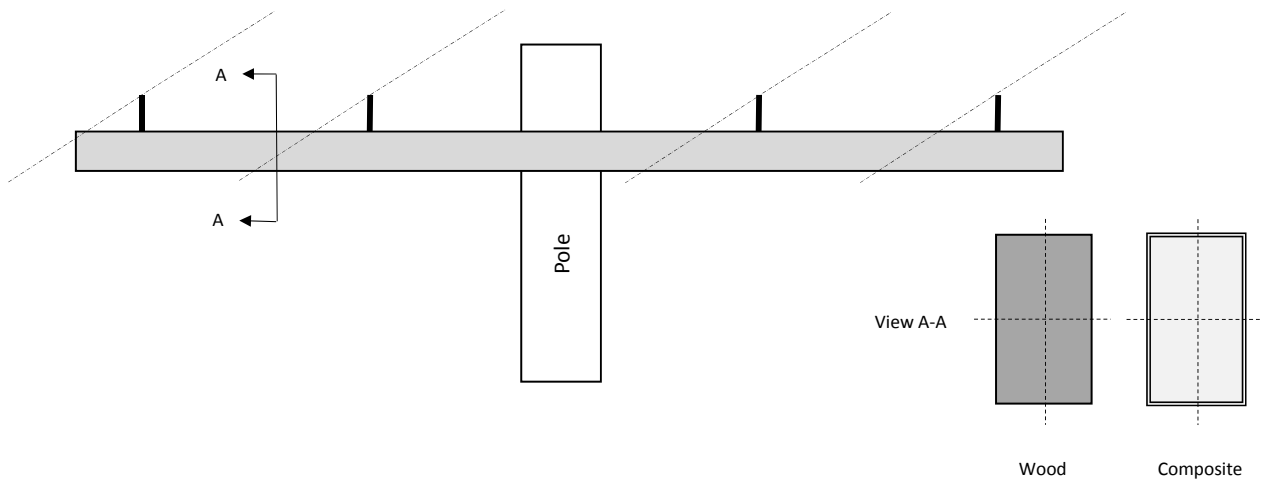

**Fig. (1a).** Typical tangent cross arm with 4 post insulator attachment points.

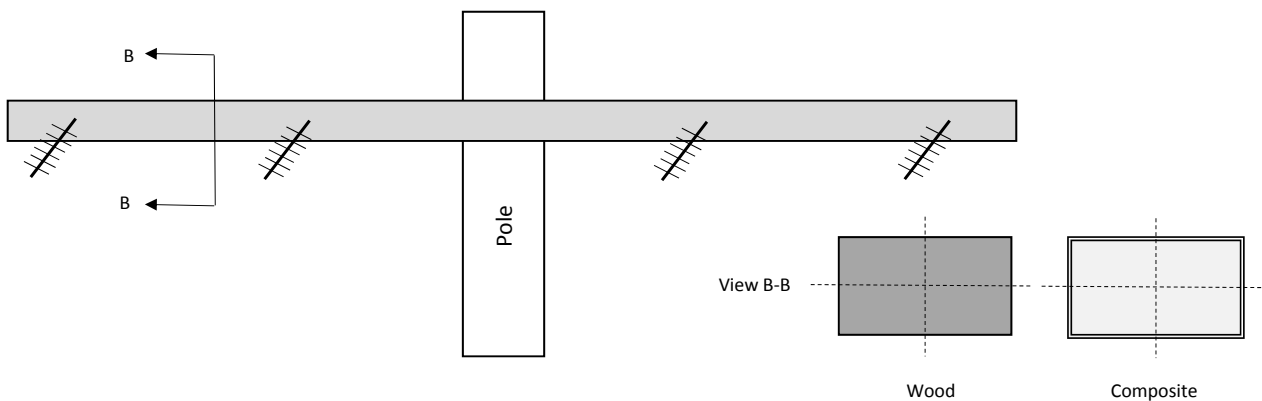

**Fig. (1b).** Typical dead end cross arm with 4 strain insulator attachment points.

To the best of our knowledge, there is little information in literature regarding the relative performance of wood and composite distribution cross arms. Parameters such as strength-to-stiffness ratios and weight-to-stiffness ratios are useful for engineers in making design choices. This study is a small step in this direction.

The objectives of this paper are to:

1. Derive relationship between wire loads and strength for wood cross arms based on ultimate design bending stress.
2. Derive relationship between wire loads and strength for composite cross arms based on test deflections.
3. Propose definitions of Strength-to-Stiffness and Weight-to-Stiffness ratios.
4. Evaluate the strength and stiffness performance of various wood and composite cross arms in both tangent and dead end configurations.
5. Compare Strength-to-Stiffness and Weight-to-Stiffness ratios of all study cases.

This study is limited to linear, elastic behavior of the structural elements. For tangent cross arms, only vertical or gravity loads are considered. For dead end cross arms, whose design is controlled by longitudinal loads, only wire tension loads are considered. Ice loads and transverse loads due to wind and line angles are not considered here but will be included in future studies.

## 2. TANGENT AND DEAD END CROSS ARMS

The six (6) configurations of tangent and dead end distribution cross arms studied in this paper are shown in Figs. (2 and 3). The selected configurations are standard designs which are commonly used by utilities [8]. Both Douglas Fir

and Southern Yellow Pine are popular materials for wood cross arms [4]; however, Douglas Fir is selected in this study for its superior strength in terms of Modulus of Elasticity.

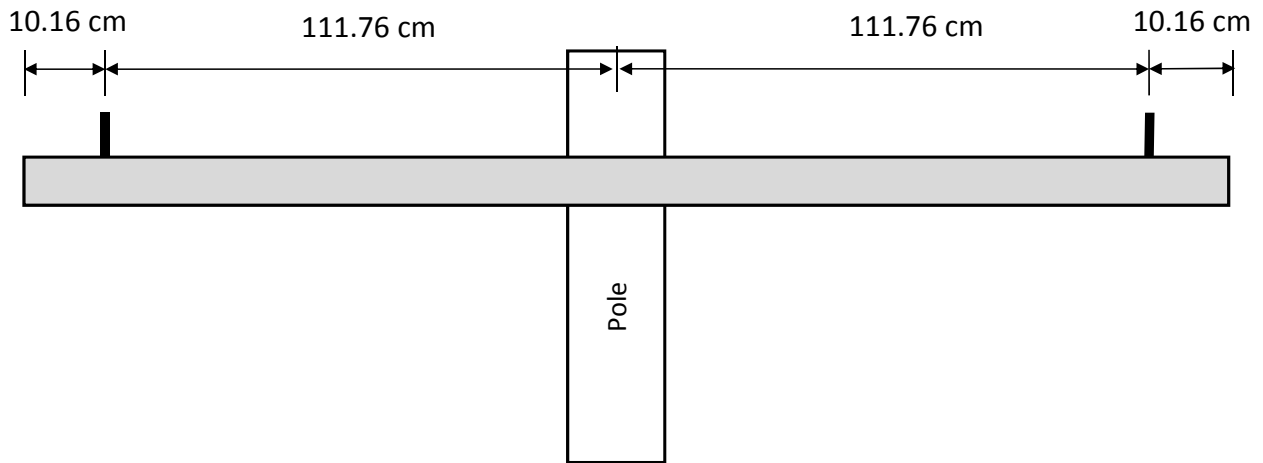

Fig. (2a). Tangent cross arm 8T (2.44 m).

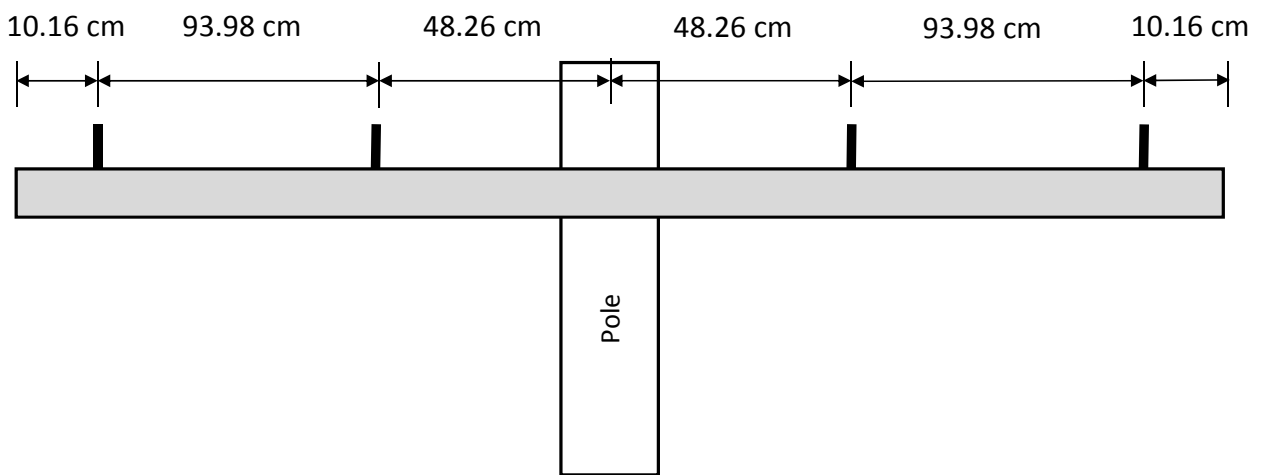

Fig. (2b). Tangent cross arm 10T (3.05 m).

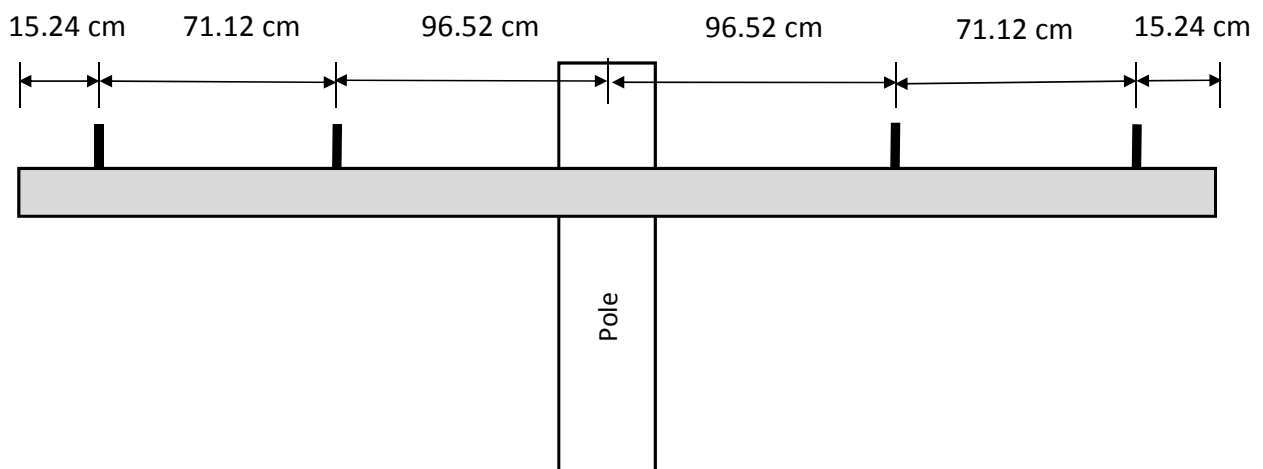

Fig. (2c). Tangent cross arm 12T (3.66 m).

**2.1. Connection to Pole**

Composite cross arms are firmly attached to the pole with a metal mounting bracket and multiple bolts. This connection is almost a fixed joint. Wood cross arms are generally connected to the pole with a single machine bolt, washer and a lock nut. This situation is closer to a pinned joint than a fixed joint. In fact, wood cross arms often have V-braces underneath to provide additional support against bending. However, in order to have consistency and facilitate a one-on-one comparison in this study, the connection at pole in both cases is considered fixed thus enabling modeling as a simple cantilever in both.

**3. MATERIAL PROPERTIES**

For cross arms made of Douglas Fir material, the designated ultimate bending stress is 51 MPa (7.4 ksi). Modulus of Elasticity ‘E’ is 13.24 GPa (1920 ksi) [4]. The dressed sizes of wood cross arms used in the study are 88.9 mm x 114.3 mm (3½ in. x 4½ in.). Material dry density for calculation purposes is taken as 6.28 kN/m<sup>3</sup> (40 pcf).

For cross arms made of composite materials, Table 1 gives the elastic properties used in the study [9]. Density of composites varies with type of manufacture but standard cross arms weigh about 0.0054 to 0.0068 kN/m (4 to 5 plf). Typical composite cross arms are similar to wood cross arms in cross sectional dimensions.

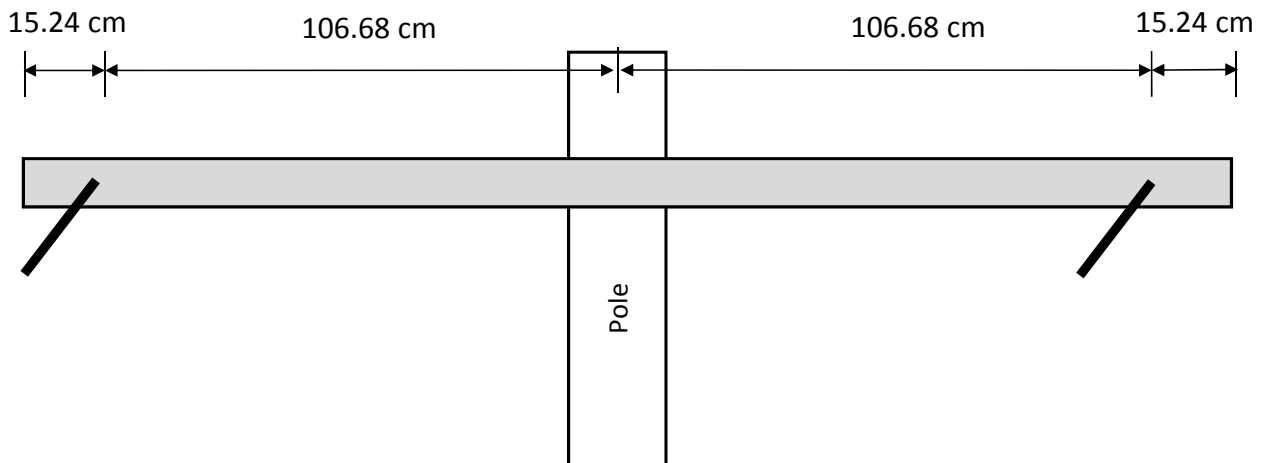

**Fig. (3a).** Dead end cross arm 8D (2.44 m).

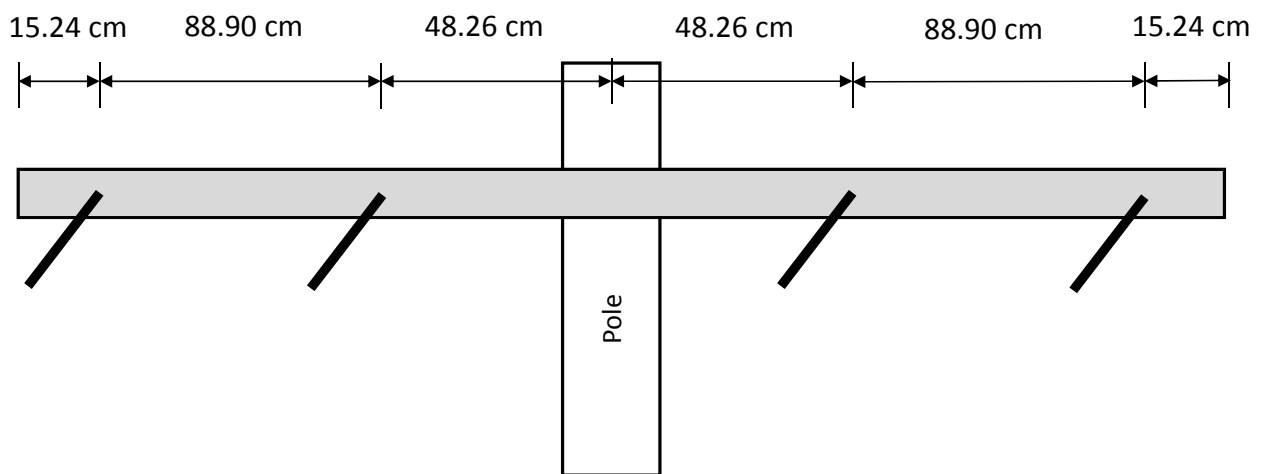

**Fig. (3b).** Dead end cross arm 10D (3.05 m).

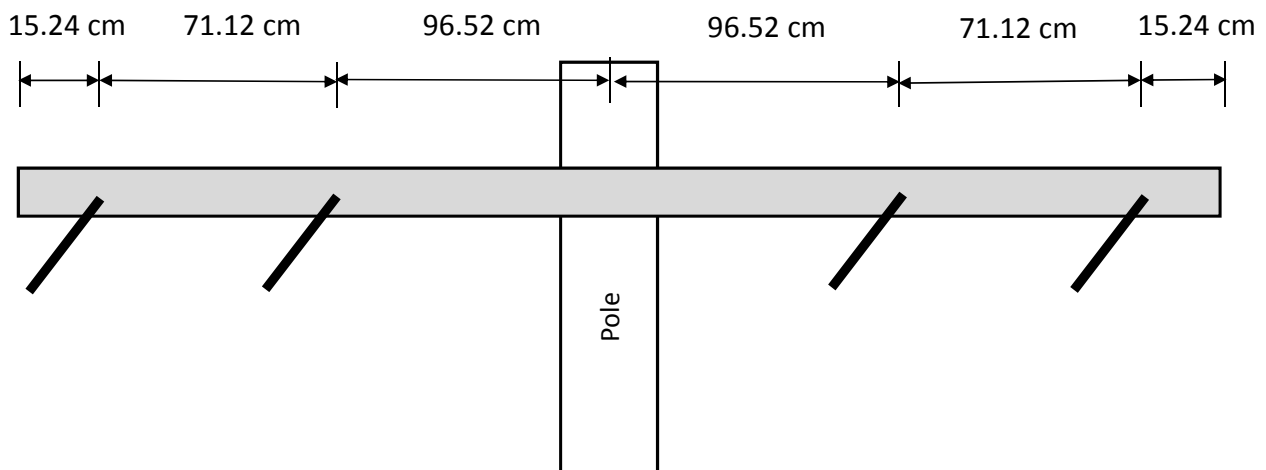

Fig. (3c). Dead end cross arm 12D (3.66 m).

Table 1. Material properties for composite cross arms [9].

Beam Series	Ave. Bending Stress - Tangent (MPa)	Ave. Bending Stress - Dead End (MPa)	Ave. Modulus of Elasticity E (GPa)	Section Dimensions (mm x mm)	Wall Thickness * (mm)
(1)	(2)	(3)	(4)	(5)	(6)
2200	257.2	342.0	33.79	92.08 x 117.48	4.57, 5.08
2000	344.8	447.5	24.82	92.08 x 117.48	6.10, 6.86
2500	462.0	513.7	35.85	92.08 x 117.48	6.10, 6.86
3000	648.1	717.1	37.92	92.08 x 117.48	8.13, 8.89

\* The two thickness values represent the thickness along long and short sides.

#### 4. LOAD CAPACITY DERIVATIONS

Figs. (4a and 4b) show the cantilever models of the cross arms analyzed. Since symmetry is available, only one half of the total cross arm is modeled.

##### 4.1. Load and Strength Factors

All loads used in the analyses include appropriate load factors. Capacities include recommended strength (reduction) factors. The values used in this study are given below [4].

Load Factor $\gamma$	Vertical Load	1.50
	Longitudinal Load	1.65 (Wire Tension)
Strength Factor $\psi$	Wood Cross Arm	0.65 (Applied to designated bending stress $f_t$ )
	Composite Cross Arm	1.00

##### 4.2. Wood Cross Arms

The derivation of the relationship between applied loads, insulator locations, deflections and cross arm bending strength is shown in Appendix A. The equations are applicable to both tangent and dead end cross arms.

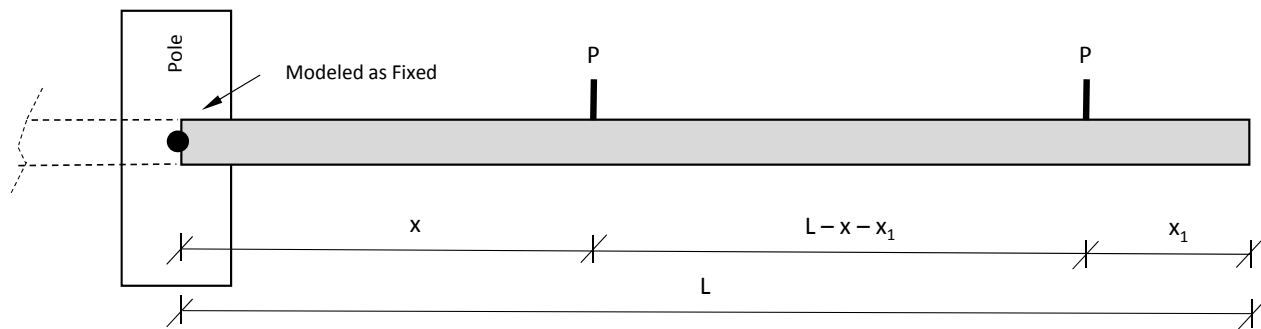

Fig. (4a). Wood cross arm cantilever model with two (2) load points.

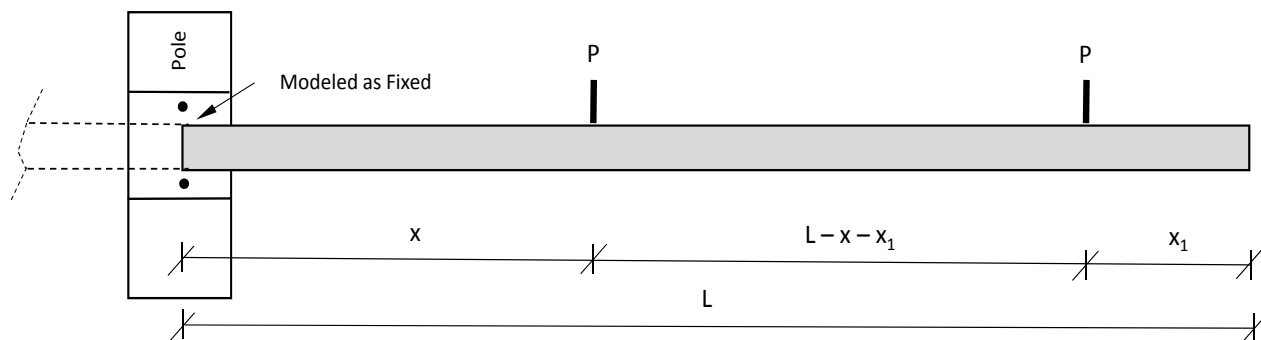

Fig. (4b). Composite cross arm cantilever model with two (2) load points.

Tables 2 and 3 show the results of application of the equations to various tangent cross arms. Three (3) wood cross arms and eleven (11) composite cross arms are studied.

Table 2. Calculations for wood tangent\*\* cross arms.

Case Id	Setup	Model Length L # (mm)	x (mm)	x <sub>1</sub> (mm)	P <sub>U</sub> (kN)	P <sub>ALL</sub> (kN)	Deflection at Free End Δ (mm)	Lateral Stiffness k <sub>L</sub> (kN/m)	Arm Weight W (N)	Strength-to-Stiffness Ratio R <sub>SS</sub> (1/mm)	Weight-to-Stiffness Ratio R <sub>WS</sub> (1/mm)	Cost (\$)
(1)	(2)	(3)	(4)	(5)	(6)	(7)	(8)	(9)	(10)	(11)	(12)	(13)
WT1	Fig. (2a)	1219.2	1117.6	101.6	8.81	5.87	31.8	969	78	9.14	0.0813	30
WT2	Fig. (2b)	1524.0	482.6	101.6	5.17	2.24	43.1	496	97	20.83	0.196	37.5
WT3	Fig. (2c)	1828.8	965.2	152.4	3.72	1.61	63.2	287	117	25.91	0.406	45
									Average	18.63	0.228	

#Corresponds to half the total length shown in setup.

\*\* γ = 1.50 and ψ = 0.65.

Table 3. Calculations for composite tangent \*\* cross arms.

Case Id *	Setup	Model Length L # (mm)	x (mm)	x <sub>1</sub> (mm)	P <sub>U</sub> (kN)	P <sub>ALL</sub> (kN)	Deflection at Free End Δ (mm)	Lateral Stiffness k <sub>L</sub> (kN/m)	Arm Weight W (N)	Strength-to-Stiffness Ratio R <sub>SS</sub> (1/mm)	Weight-to-Stiffness Ratio R <sub>WS</sub> (1/mm)	Cost (\$)
(1)	(2)	(3)	(4)	(5)	(6)	(7)	(8)	(9)	(10)	(11)	(12)	(13)
CT1	Fig. (2a)	1219.2	1117.6	101.6	15.57	6.75	62.5	871.8	76	17.88	0.087	56
CT2	Fig. (2b)	1524.0	482.6	101.6	12.23	5.30	113.3	446.4	89	54.76	0.199	68
CT3	Fig. (2a)	1219.2	1117.6	101.6	28.47	18.97	121.2	821.7	93	34.62	0.114	56
CT4	Fig. (2b)	1524.0	482.6	101.6	24.02	16.01	236.1	420.7	111	114.1	0.356	69

(Table 5) contd....

Case Id *	Setup	Model Length L # (mm)	x (mm)	x <sub>1</sub> (mm)	P <sub>U</sub> (kN)	P <sub>ALL</sub> (kN)	Deflection at Free End Δ (mm)	Lateral Stiffness k <sub>L</sub> (kN/m)	Arm Weight W (N)	Strength-to-Stiffness Ratio R <sub>SS</sub> (1/mm)	Weight-to-Stiffness Ratio R <sub>WS</sub> (1/mm)	Cost (\$)
CT5	Fig. (2c)	1828.8	965.2	152.4	18.68	12.45	259.1	351.7	125	106.2	0.354	84
CT6	Fig. (2a)	1219.2	1117.6	101.6	33.36	22.24	98.3	1186.9	98	28.1	0.082	79
CT7	Fig. (2b)	1524.0	482.6	102.6	26.69	17.8	181.6	607.7	116	87.8	0.190	92
CT8	Fig. (2c)	1828.8	965.2	152.4	24.46	16.31	339.1	351.7	129	139.0	0.366	118
CT9	Fig. (2a)	1219.2	1117.6	101.6	44.48	29.65	100.4	1549.9	120	28.68	0.077	79
CT10	Fig. (2b)	1524.0	482.6	152.4	41.81	27.87	217.9	793.5	138	105.3	0.174	92
CT11	Fig. (2c)	1828.8	965.2	152.4	35.58	23.72	377.8	459.2	160	154.9	0.345	118
									Average	79.213	0.213	

\* CT1, CT2 Beam Series 2200 CT3, CT4 Beam Series 2000 (Courtesy: Geotek, Inc.).

CT5 to CT8 Beam Series 2500 CT9 to CT11 Beam Series 3000.

\*\* γ = 1.50 and ψ = 1.00.

# Corresponds to half the total length shown in setup.

### 4.3. Composite Cross Arms

The derivation of the relationship between test loads, insulator locations, deflections and cross arm bending strength is shown in Appendix B. The equations are applicable to both tangent and dead end cross arms.

Tables 4 and 5 show the results of application of the equations to various dead end cross arms. Three (3) wood cross arms and eight (8) composite cross arms are studied.

Table 4. Calculations for wood dead end \*\* cross arms.

Case Id	Setup	Model Length L # (mm)	x (mm)	x <sub>1</sub> (mm)	P <sub>U</sub> (kN)	P <sub>ALL</sub> (kN)	Deflection at Free End Δ (mm)	Lateral Stiffness k <sub>L</sub> (kN/m)	Arm Weight W (N)	Strength-to-Stiffness Ratio R <sub>SS</sub> (1/mm)	Weight-to-Stiffness Ratio R <sub>WS</sub> (1/mm)	Cost (\$)
(1)	(2)	(3)	(4)	(5)	(6)	(7)	(8)	(9)	(10)	(11)	(12)	(13)
WD1	Fig. (3a)	1219.2	1066.8	152.4	9.22	3.63	31.0	969	78	9.40	0.080	30
WD2	Fig. (3b)	1524.0	482.6	152.4	5.34	2.11	42.1	496	97	21.34	0.196	37.5
WD3	Fig. (3c)	1828.8	965.2	152.4	3.73	1.47	63.2	287	117	25.91	0.406	45
									Average	18.88	0.227	

# Corresponds to half the total length shown in setup.

\*\* γ = 1.65 and ψ = 0.65.

All four tables also show the relative weights and costs of the cross arms modeled.

### 5. STIFFNESS RATIOS

We propose two (2) ratios here with reference to cross arm strength, stiffness and weight.

$$\text{Strength-to-Stiffness Ratio } R_{SS} = \text{No. of Load Points} * \text{Ultimate P per Load Point} / \text{Lateral Flexural Stiffness} = (n_p) (P_U) / k_L \tag{1}$$

$$\text{Weight-to-Stiffness Ratio } R_{WS} = \text{Total Weight of the Arm} / \text{Lateral Flexural Stiffness} = W / k_L \tag{2}$$

The lateral flexural stiffness k<sub>L</sub> is given by finite element method as 12 EI / L<sup>3</sup> where EI is the flexural rigidity of the cross section and L is the length of the element.

Evaluated lateral flexural stiffness of all cases are shown in the tables. The units of both R<sub>SS</sub> and R<sub>WS</sub> are 1/mm (1/in).

### 6. DISCUSSION

As seen in Table 1, average bending stress capacities for composites are 5 to 14 times than those of wood. The modulus of elasticity, E, which controls stiffness and thereby deflections, is about 1.9 to 2.9 times larger for composites than for wood. These two parameters govern the behavioral differences between the two materials.

Tables 2 to 5 show the main differences between wood and composite arms. While the composite arms exhibited larger strength-to-stiffness ratios, there is little difference between the two materials with reference to weight-to-stiffness ratios. However, from deformation point of view, composite arms sustained deflections 4 to 5 times larger than wood arms.

Tables 2 to 5 also show the allowable loads on cross arms computed considering nominal NESC load and strength factors. As expected, composite cross arms showed larger load bearing capacity than wood arms of the same length and configuration.

Cost-wise, composite cross arms are about 2 to 2¼ times costlier than wood arms based on nominal market prices. But, the additional cost is offset by superior load-deflection performance and flexibility while subject to large loads.

**Table 5. Calculations for composite dead end \*\* cross arms.**

Case Id #	Setup	Model Length L # (mm)	x (mm)	x <sub>1</sub> (mm)	P <sub>U</sub> (kN)	P <sub>ALL</sub> (kN)	Deflection at Free End Δ (mm)	Lateral Stiffness k <sub>L</sub> (kN/m)	Arm Weight W (N)	Strength-to-Stiffness Ratio R <sub>SS</sub> (1/mm)	Weight-to-Stiffness Ratio R <sub>WS</sub> (1/mm)	Cost (\$)
(1)	(2)	(3)	(4)	(5)	(6)	(7)	(8)	(9)	(10)	(11)	(12)	(13)
CD1	Fig. (3a)	1219.2	1066.8	152.4	35.58	21.57	103.5	1118.4	116	31.80	0.104	56
CD2	Fig. (3b)	1524.0	482.6	152.4	22.24	13.48	152.9	572.6	147	77.62	0.256	69
CD3	Fig. (3a)	1219.2	1066.8	152.4	44.48	26.96	176.0	821.7	120	54.10	0.147	56
CD4	Fig. (3b)	1524.0	482.6	152.4	26.69	16.17	249.8	420.7	151	126.80	0.358	69
CD5	Fig. (3c)	1828.8	965.2	152.4	18.68	11.32	258.9	351.7	165	106.2	0.467	84
CD6	Fig. (3a)	1219.2	1066.8	152.4	65.38	39.62	145.1	1465.3	142	44.70	0.096	79
CD7	Fig. (3b)	1524.0	482.6	152.4	44.48	26.96	233.5	750.2	186.8	118.49	0.249	92
CD8	Fig. (3c)	1828.8	965.2	152.4	31.1	18.9	349.6	434.2	214	143.3	0.490	118
									Average	87.88	0.271	

\*CD1, CD2 Beam Series 2200 (Courtesy: Geotek, Inc.).

CD3, CD4 Beam Series 2000.

CD5 to CD8 Beam Series 2500.

\*\*  $\gamma = 1.65$  and  $\psi = 1.00$ .

# Corresponds to half the total length shown in setup.

## CONCLUSION

A total of 25 distribution cross arms made of wood and composites are analyzed. Both tangent and dead end configurations are studied using specially derived load-deflection relationships. Though the study comprised only of a small set of data, the following main conclusions can be drawn.

1. Composite arms consistently showed large strength-to-stiffness ratios relative to wood arms. On an average, the R<sub>SS</sub> ratios of composite arms are over 4 times than those of wood.
2. Composite arms sustained deflections 4 to 5 times larger than wood arms at ultimate load levels.
3. Composite arms showed larger load carrying capacity than wood arms of similar configurations.
4. However, composite arms are more than twice as expensive as wood arms. This additional expense is however offset by their superior performance and flexibility at higher load levels.

## LIST OF NOTATIONS

<b>a</b>	=	Diameter of Bolt Hole
<b>b</b>	=	Width of Cross Section
<b>d</b>	=	Depth of Cross Section
<b>E</b>	=	Modulus of Elasticity
<b>f<sub>r</sub></b>	=	Designated Bending Stress for Wood (MOR)
<b>I</b>	=	Moment of Inertia
<b>k<sub>L</sub></b>	=	Lateral Flexural Stiffness of Beam
<b>L</b>	=	Length of Cross Arm as Shown
<b>M<sub>a</sub></b>	=	Applied Moment



$M_s$	=	Moment Capacity Based on Designated Bending Stress $f_r$
$n_p$	=	Number of Load Points
$P$	=	Load
$P_U$	=	Ultimate or Maximum Load
$P_{ALL}$	=	Allowable Load = $\psi P_U / \gamma$
$P_T$	=	Test Load
$R_{SS}$	=	Strength-to-Stiffness Ratio
$R_{WS}$	=	Weight-to-Stiffness Ratio
$W$	=	Weight of Cross Arm
$x, x_1$	=	Load Point Locations as shown in Figure 4
$y$	=	Distance to Extreme Fiber of Wood Cross Section
$\Delta_{1-wire}$	=	Deflection of Cross Arm at Free End for One Load Point
$\Delta_{2-wire}$	=	Deflection of Cross Arm at Free End for Two Load Points
$\Delta_{T1}$	=	Test Deflection of Cross Arm at Free End for One Load Point
$\Delta_{T2}$	=	Test Deflection of Cross Arm at Free End for Two Load Points
$\gamma$	=	Load Factor for Given Load
$\Psi$	=	Strength Reduction Factor for Cross Arm Material
$\eta_1, \eta_2$	=	Parameters as Defined

**CONSENT FOR PUBLICATION**

Not applicable.

**CONFLICT OF INTEREST**

The authors declare no conflict of interest, financial or otherwise.

**ACKNOWLEDGEMENTS**

The authors wish to acknowledge the assistance of Geotek Inc., of Stewartville, Minnesota during work on this article.

**APPENDIX A**

Wood Cross Arms - Correlation between Strength and Applied Loads

Referring to Fig. (4a):

Moment at fixed end due to applied loads  $P = P_U$ :

$$M_a = P_U * x + P_U * (L-x_1) = P_U * (L+ x - x_1) \tag{A-1}$$

Moment capacity based on designated bending stress,  $f_r$  [9]:

$$M_s = f_r * (b * d^3) / (12 * y) \tag{A-2}$$

Modifying depth 'd' to account of bolt hole 'a' at the pole-arm connection [6]:

$$M_s = f_r * b * (d^3 - a^3) / 6 * d \tag{A-3}$$

Equating the applied moment and ultimate capacity:

$$P_U * (L+ x - x_1) = f_r * b * (d^3 - a^3) / 6 * d \tag{A-4}$$

or

$$P_U = f_r * b * (d^3 - a^3) / (6 * d) * (L+ x - x_1) \text{ for 2 wires} \tag{A-5}$$

$$P_U = f_r * b * (d^3 - a^3) / (6 * d) * (L - x_1) \text{ for 1 wire} \quad (\text{A-6})$$

For the single-wire case, only the load at the far end of the cantilever beam is considered.

#### Deflections

From basic statics, we have deflection at the arm free end as [10]:

$$\Delta_{1\text{-wire}} = P_U * (L - x_1)^2 * (2L + x_1) / (6 * E * I) \quad (\text{A-7})$$

$$\Delta_{2\text{-wire}} = P_U * (L - x_1)^2 * (2L + x_1) / (6 * E * I) + P_U * x^2 * (3L - x) / (6 * E * I) \quad (\text{A-8})$$

Allowable Load  $P_{ALL}$

Recommended strength reduction factor =  $\psi$

$$P_{ALL} = \psi * P_U / \text{Load Factor } \gamma \quad (\text{A-9})$$

Note: Standard bolts used on wood cross arms are 15.88 mm (5/8 in.) in diameter and the corresponding bolt holes are 17.46 mm (11/16 in.).

## APPENDIX B

### Composite Cross Arms - Correlation between Test Results and Applied Loads

Referring to Fig. (4b) and Appendix A, the deflections at the arm free end in general are:

$$\Delta_{1\text{-wire}} = P * (L - x_1)^2 * (2L + x_1) / (6 * E * I) \quad (\text{B-1})$$

$$\Delta_{2\text{-wire}} = P * (L - x_1)^2 * (2L + x_1) / (6 * E * I) + P * x^2 * (3L - x) / (6 * E * I) \quad (\text{B-2})$$

Evaluating these deflections with load values  $P_T$  determined in tests:

$$\Delta_{T1} = P_T * (L - x_1)^2 * (2L + x_1) / (6 * E * I) \quad (\text{B-3})$$

$$\Delta_{T2} = P_T * (L - x_1)^2 * (2L + x_1) / (6 * E * I) + P_T * x^2 * (3L - x) / (6 * E * I) \quad (\text{B-4})$$

or

$$\Delta_{T1} = P_T * \eta_1 / (6 * E * I) \text{ 1-wire} \quad (\text{B-5})$$

$$\Delta_{T2} = P_T * \eta_2 / (6 * E * I) \text{ 2-wire} \quad (\text{B-6})$$

where:

$$\eta_1 = (L - x_1)^2 * (2L + x_1) \quad (\text{B-7a})$$

$$\eta_2 = [(L - x_1)^2 * (2L + x_1) + x^2 * (3L - x)] \quad (\text{B-7b})$$

For the single-wire case, only the load at the far end of the cantilever beam is considered.

Allowable load

Recommended strength reduction factor =  $\psi$

$$\text{Allowable Load } P_{ALL} = \psi * P_T / \text{Load Factor } \gamma \quad (\text{B-8})$$

## REFERENCES

- [1] S. Kalaga, "Composite transmission and distribution poles – A new trend", *Energy Cent., Grid Operations*, 2013. October
- [2] *Bulletin 1728F-803, "Specifications and Drawings for 24.9/14.4 kV Line Construction.*, Rural Utilities Service, United States Department of Agriculture: Washington, DC, 1998.
- [3] *Bulletin 1728F-804, "Specifications and Drawings for 12.5/7.2 kV Line Construction.*, Rural Utilities Service, United States Department of Agriculture: Washington, DC, 2005.
- [4] *Bulletin 1724E-200, "Design Manual for High Voltage Transmission Lines.*, Rural Utilities Service, United States Department of Agriculture: Washington, DC, 2015.
- [5] *Bulletin 1724E-151, "Mechanical Loading on Distribution Cross Arms.*, Rural Utilities Service, United States Department of Agriculture: Washington, DC, 2002.

- [6] ASCE Manual of Practice 104, *Recommended Practice for Fiber-Reinforced Polymer Products for Overhead Utility Line Structures*, 2003.
  - [7] *National Electrical Safety Code, ANSI-C2.*, Institute of Electrical and Electronics Engineers, 2012.
  - [8] Hughes Brothers Inc., *Transmission Product Catalog.*, Hughes Brothers: Seward, Nebraska, USA, 2012.
  - [9] Geotek Inc, *PUPI Cross Arm Technical Manual.*, Geotek: Stewartville, Minnesota, USA, 2005.
  - [10] I. Mikhelson, *Structural Engineering Formulas.*, McGraw-Hill: New York, New York, 2004.
- 

© 2017 Pidaparti and Kalaga.

This is an open access article distributed under the terms of the Creative Commons Attribution 4.0 International Public License (CC-BY 4.0), a copy of which is available at: <https://creativecommons.org/licenses/by/4.0/legalcode>. This license permits unrestricted use, distribution, and reproduction in any medium, provided the original author and source are credited.